

**Part No:** 854-200CFP

**Fabricated Fittings**

**Flanges and Cut in Kits**

**Desc:** 20 CPVC V/S FLANGE SOC 50PSI PLAST RING

**MSRP:** 10233.29

**Part Code:** 097

**Weight(lbs):** 60.252

**Weight(kg):** 27.33

**Weight(gm):** 27330

**Size:** 20

**Color:** GRAY

**Material:** CPVC

**Joint Style** IPS

**Connection** Socket

**Ring** Plastic

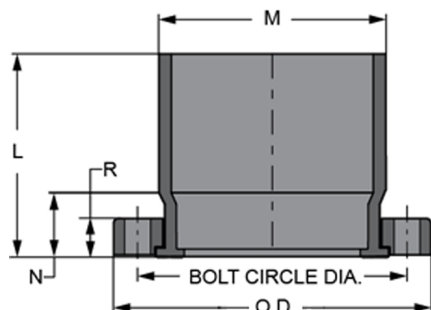

**L** = 15-5/8

**Min. Bolt Length** = 5-1/2

**R** = 1- 1/2

**No of Bolts** = 20

**Bolt Circle Dia.** = 25

**Bolt Size** = 1- 1/8

**M** = 21- 3/16

**N** = 5-5/8

**O.D.** = 27- 1/2

## Fabricated Dimension References:

**G** = (LAYING LENGTH) intersection of center lines to bottom of socket/thread; 90° elbows, tees, crosses; ± 1/4 & larger ± 1/2 inch.

**H** = Intersection of center lines to face of fitting; 90° elbows, tees, crosses; ± 1/4 inch.; wyes ± 1/2 inch; 14" & larger inch.

**J** = Intersection of center lines to bottom of socket/thread; 45° elbows; ± 1/4 inch; 14" & larger ± 1/2 inch.

**L** = Overall length of fittings; ± 1/2 inch; wyes ± 1 inch; 14" & larger ± 1 inch.

**M** = Outside diameter of socket/thread hub; ± 1/4 inch.

**N** = Socket bottom to socket bottom; couplings; ± 1/2 inch.

**W** = Height of cap; ± 1/4 inch.

## Typical Fabricated Dimension References

