

Spray Balls

Stationary Spray Balls - STC

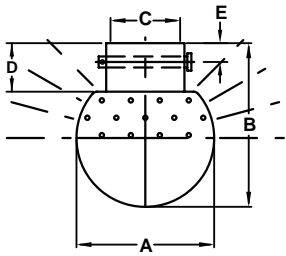

180° Top Pattern

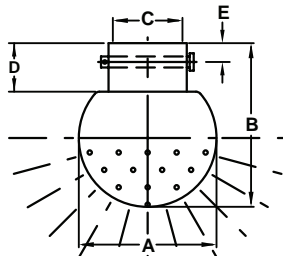

180° Bottom Pattern

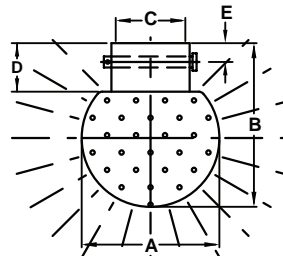

360° Pattern



Application:

- typically used in food and beverage industries for cleaning storage tanks

Features:

- heavy duty 316L stainless steel construction provides longer life
- stationary - designed to be mounted to a tube or pipe
- 2 mm spray holes
- various spray patterns available (blanks available as special order)

Size	Pin Length	Spray Pattern	Dimensions					Pin Size	316L Stainless Steel	
			A	B	C	D	E		Part #	Price/E
1"	1.47"	360°	3.04"	2.95"	1.005"	.975"	.445"	.226"	STC-360-R100	\$121.05
1½"	1.95"	360°	3.54"	2.95"	1.505"	.975"	.445"	.226"	STC-360-R150	186.65
1"	1.47"	180° bottom	3.54"	2.95"	1.005"	.975"	.445"	.226"	STC-180B-R100	123.20
1½"	1.95"	180° bottom	3.54"	2.95"	1.505"	.975"	.445"	.226"	STC-180B-R150	175.95
1"	1.47"	180° top	3.54"	2.95"	1.005"	.975"	.445"	.226"	STC-180T-R100	123.20
1½"	1.95"	180° top	3.54"	2.95"	1.505"	.975"	.445"	.226"	STC-180T-R150	175.95

Repair Kits

Repair kit contains:

- (1) pin
- (1) R clip

Size	Part #	Price/E
1"	STC-RK100	\$8.85
1½"	STC-RK150	9.10



Technical Data

